MATHEW TECH MK86

3-Mode RGB Mechanical Keyboard

<http://www.mathewkb.com>

Version:1.0

2023/04/10

By:MATHEW

Basic Parameters

Product model:DK86

Keyboard interface:USB TYPE-C

System compatibility: Windows/Mac/IOS/Android

Input:5V = 1A

Battery capacity: 5000mAh (different versions have different capacities)

Connection method:Tri-mode connection

Bluetooth name:DK86 BT3.0 / DK86 BT5.0

Backlight color: Full color RGB/Monochrome

Product size: 36.8×14.3×4.3CM

Package contents: Keyboard/Data cable/
Instruction manual/Receiver

Charging Indication

When the battery is low, the right FN key keeps flashing red until the keyboard is power off.When you plug in the Type-C cable for charging, the FN key is steady red for 3 seconds, and then it synchronously prompts the backlight to charge. Note *: The battery of this product shall not be exposed to the sun. **The input voltage is limited to 5V (overvoltage may cause damage to the product and cannot enjoy warranty service).**

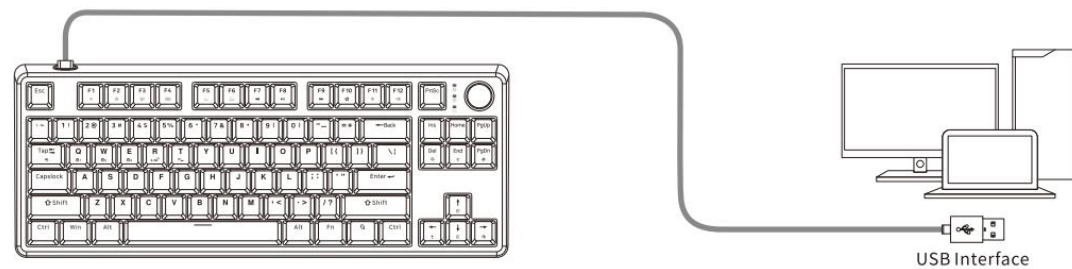

Indicator Light/Knob

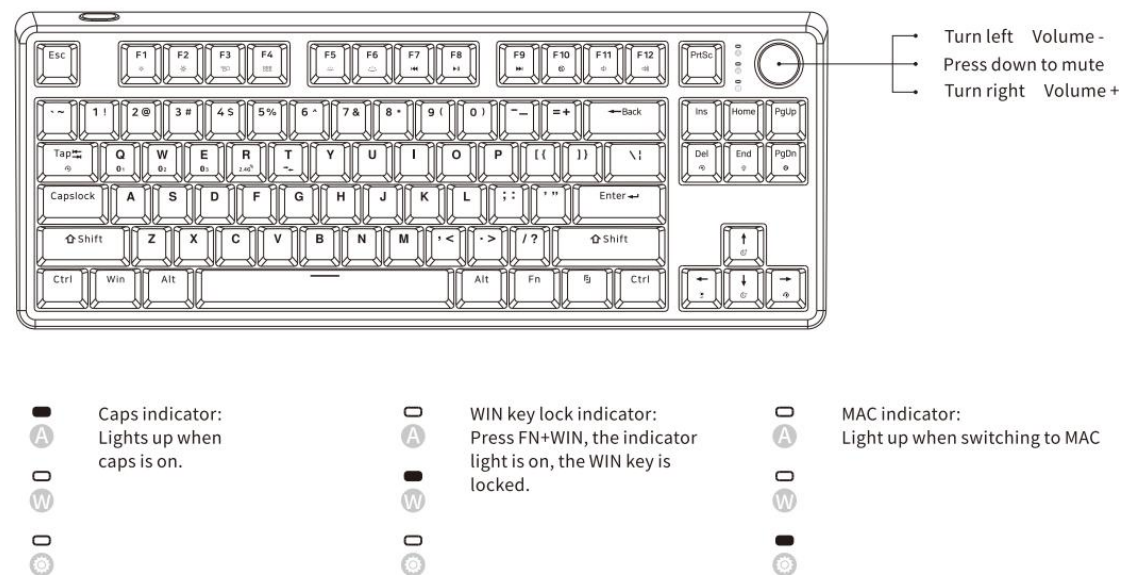

Three Stage Switch/System Switch

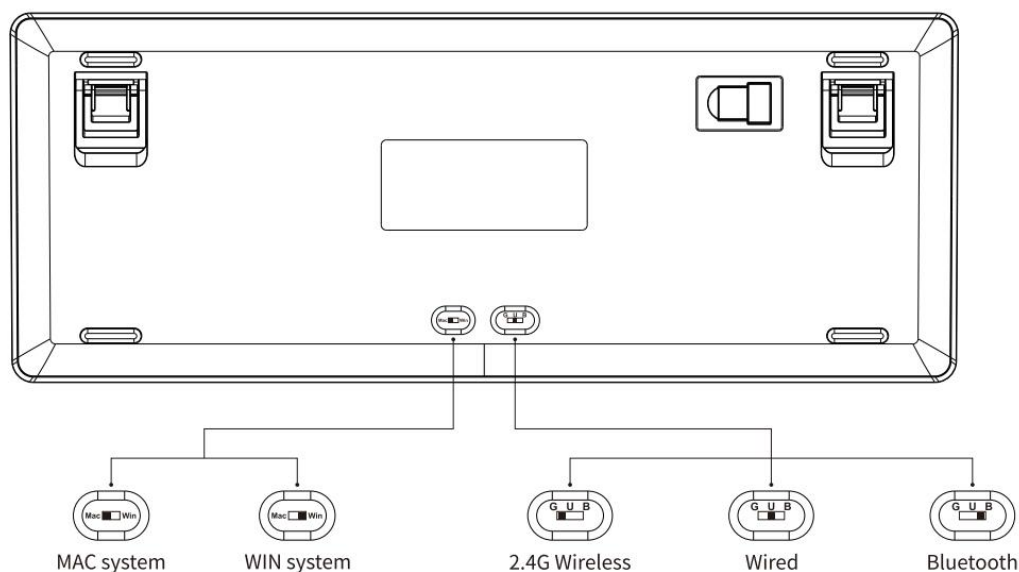

Bluetooth/2.4G Wireless/Wired Connection

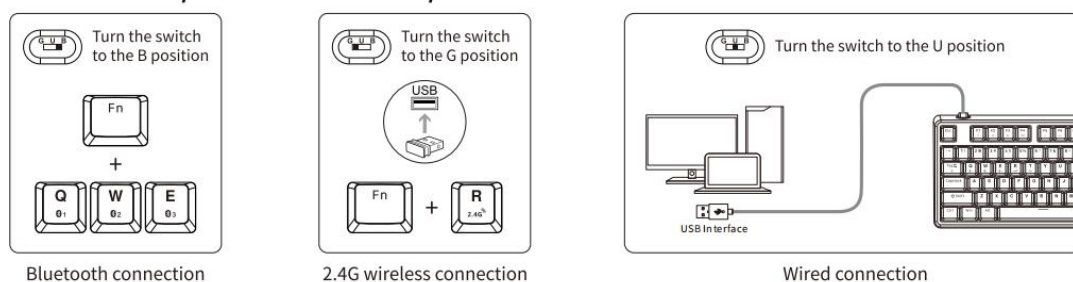

Bluetooth connection method

Turn the bottom switch to the "B" gear and connect the Bluetooth as follows:

- Bluetooth device 1: Long press for 3 seconds FN+Q (Q) light flashes quickly, search DK86BT5.0/DK86BT3.0 on the device and click Connect. After successful code alignment, the light of Q key will synchronize with the backlight
- Bluetooth device 2: Long press for 3 seconds FN+W (W) light flashes quickly, search DK86BT5.0/DK86BT3.0 on the device and click Connect. After successful code alignment, the light of W key will synchronize with the backlight
- Bluetooth device 3: Long press for 3 seconds FN+E (E) light flashes quickly, search DK86BT5.0/DK86BT3.0 on the device and click Connect. After successful code alignment, E key light will synchronize with the backlight

1. Bluetooth channel switching: Short press FN+Q/W/E when switching devices 1.2.3. If the corresponding indicator blinks quickly when switching Bluetooth devices, the code needs to be re-aligned

2. Code 2.4G: Turn the bottom switch to the "G" gear, long press FN+R key for 3 seconds corresponding to the backlight green flash, insert the receiver into the PC, and synchronize the light with the backlight after code matching

3. Wired connection: turn the bottom switch to the "U" gear, and plug the data cable Type-c interface into the keyboard interface and the USB interface into the computer interface

Keyboard Backlight Recording Method

Backlight record key combination



Backlight recording mode steps

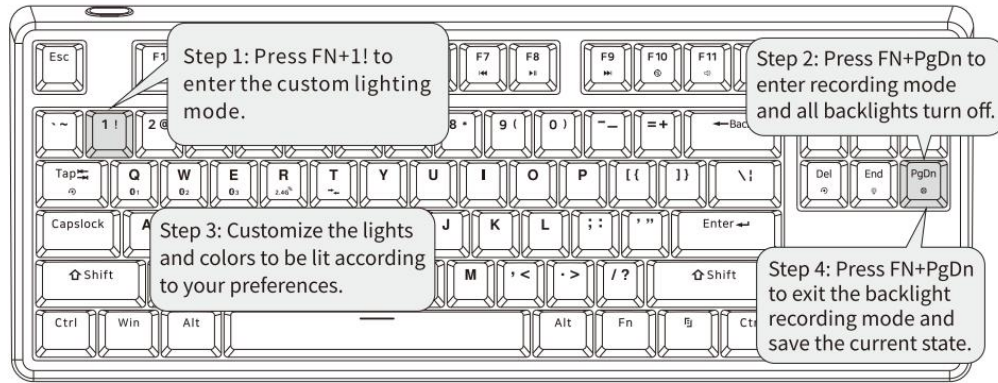

FN Key Combination

WIN system shortcut keys



FN + F1	Screen brightness-	FN + F5	Keyboard backlight brightness-	FN + F9	Next track
FN + F2	Screen brightness+	FN + F6	Keyboard backlight brightness+	FN + F10	Mute
FN + F3	Multitasking windows	FN + F7	Previous	FN + F11	Volume-
FN + F4	Program list	FN + F8	Pause/Play	FN + F12	Volume+

Note: Only computers that support shortcut key brightness adjustment in the Windows system can adjust the screen brightness.

MAC system shortcut keys



Turn the system switch left to Mac to access the Mac system

F1	Screen brightness-	F5	Keyboard backlight brightness-	F9	Next track
F2	Screen brightness+	F6	Keyboard backlight brightness+	F10	Mute
F3	Multitasking windows	F7	Previous	F11	Volume-
F4	Program list	F8	Pause/Play	F12	Volume+

Note: FN+(F1-F12) in MAC system corresponds to F1-F12 keys, directly press F1-F12 corresponding to multimedia functions in MAC system.

Backlight shortcut keys

FN + Tab	Backlight mode switching	FN + End	Turn off/on backlight
FN + ↑	Backlight speed+	FN + ←	Dynamic backlight direction switching
FN + ↓	Backlight speed-	FN + →	Backlight monochrome switching (monochrome keyboard without this function)

Special shortcut keys

FN + Del	Press and hold for 3 seconds to restore factory settings	FN + T	Display wireless pairing channel
----------	--	--------	----------------------------------

Special function

Display the remaining electricity (alphanumeric key 1! to 0) represent 10%-100% of electricity respectively. When the power level is 30% or below, the 123 key lights on red. When the power level is 60% or below, 123456 key lights on blue. When the power level is 100% or below, 1234567890 key lights on green.)