



USER GUIDE

Mechanical Keyboard

※ S68 Mechanical keyboard ※

Manufacturer: MATHEW TECHNOLOGY LIMITED

www.mathewkb.com

Execution standards : GB 4943.1-2022

Product Diagram



Note: Product due to different production batches of key position or function will be slightly changed, subject to the actual prod The factory specifications of the product are semi-finished products without key caps, customizable DIY mechanical keyboard

DIY replacement keyboard switch

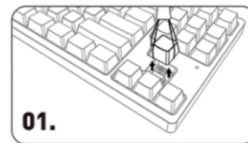

01. Remove the key cap with a key puller

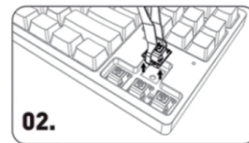

02. Use a switch puller to pull out the switch body



03. Check the installation position of the switch



04. Place the new switch on the card position

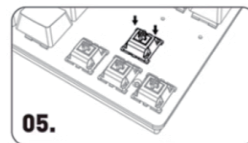

05. Gently press the light switch stop position

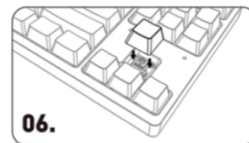

06. Just install the keycap

Connection

2. 4G Pairing:

After the keyboard is turned on, press Fn+R to enter 2.4G mode. At this time, the R key flash slowly, long press Fn+R for 3seconds to enter pairing mode. The R key flash quickly plug the receiver now. After pairing success, the R key will stop flashing

Bluetooth Pairing:

After the keyboard is turned on, press Fn+Q/W/E to enter bluetooth mode. At the same time, the Q/W/E flash slowly, long press Fn+Q/W/E for 3seconds to enter Pairing mode. The Q/W/E flash quickly, open your computer bluetooth and searching, once keyboard show up, connect the keyboard. After pairing success, The Q/W/E will stop flashing.

Wired connection: Turn off the keyboard, plug type-c cable, then press Fn+T enter wired mode.

For more function like keymap: visit www.mathewkb.com and download driver and program it.

Multimedia Keys

Fn Combination Keys			
Fn+Esc (3S)	Reset	Fn+Win	Lock/Unlock Win
Fn+1!	F1	Fn+7&	F7
Fn+2@	F2	Fn+8*	F8
Fn+3#	F3	Fn+9(F9
Fn+4\$	F4	Fn+0)	F10
Fn+5%	F5	Fn+-_	F11
Fn+6^	F6	Fn+=+	F12
Fn+I	Prtsc	Fn+J	Ins
Fn+O	Scrlk	Fn+K	Home
Fn+P	Pause	Fn+L	END
Fn+	Backlight brightness-	Fn+	Backlight brightness+
Fn+	Light speed+	Fn+	Light speed-
Fn+`~	backlight effect switching	Fn+Enter	Off/On backlight

Keyboard Specification

Connection Method:	Wired	Number of Keys:	68
Interface Type:	Wired/BT/2.4G	Working Current:	150mA
Working Voltage:	DC 5V±5%	Cable Length:	1.5m±3cm

Product Instruction

1. This product is a tri-mode custom mechanical keyboard. It supports wireless connection and USB A to C wired connection.
2. The product supports Vista/Win ME/Win2000/WinXP/Win7/Win8/Win10/Win11/Android/Linux/Mac and other operating systems.

If this device does not work properly, please check if the USB port of the computer works rightly, and if the cable is broken.

Avoid using this device in a strong sunlight, high temperature or dusty environment.

Avoid using this device in a water ingress or humid environment.



Quick support in discord